

**SEPARATE CAST
IN PLACE BASE**

1" MIN
2 1/2" MAX

**PRECAST BASE
WITH INTEGRAL RISER**

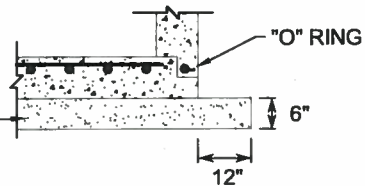

GRAVEL BACKFILL FOR
PIPE ZONE BEDDING

SEPARATE PRECAST BASE

NOTES:

1. For details showing grade ring, ladder, steps, handholds and top slabs, see Standard Plan No. SU-21.
2. Non-reinforced concrete in channel and shelf shall be Class 3000. All precast concrete shall be Class 4000.
3. Rubber gaskets shall be used in tongue and groove joints of pre-cast sections.
4. A flexible pipe-to-manhole connector shall be employed in all connections of rigid and flexible pipes to new precast concrete manholes. The connector shall be "Kor-N-Seal" with "Wedge Korband" manufactured by NPC, Inc., or approved equal.
5. Base reinforcing steel shall be per manufacturer's recommendation.

MANHOLE DIMENSION TABLE

INSIDE DIAMETER	MINIMUM WALL THICKNESS	MINIMUM BASE THICKNESS	MAXIMUM HOLE SIZE	MINIMUM DISTANCE BETWEEN HOLES
48"	4"	6"	36"	8"
54"	4 1/2"	8"	42"	8"
60"	5"	8"	48"	8"

CITY OF TACOMA
DEPARTMENT OF PUBLIC WORKS

APPROVED FOR PUBLICATION

[Signature]
CITY ENGINEER

[Signature]
DATE

MANHOLE-TYPE 1
48", 54" AND 60"

STANDARD PLAN NO. SU-17