

**RETAINING WALL WITHOUT VEHICLE SURCHARGE**

NTS

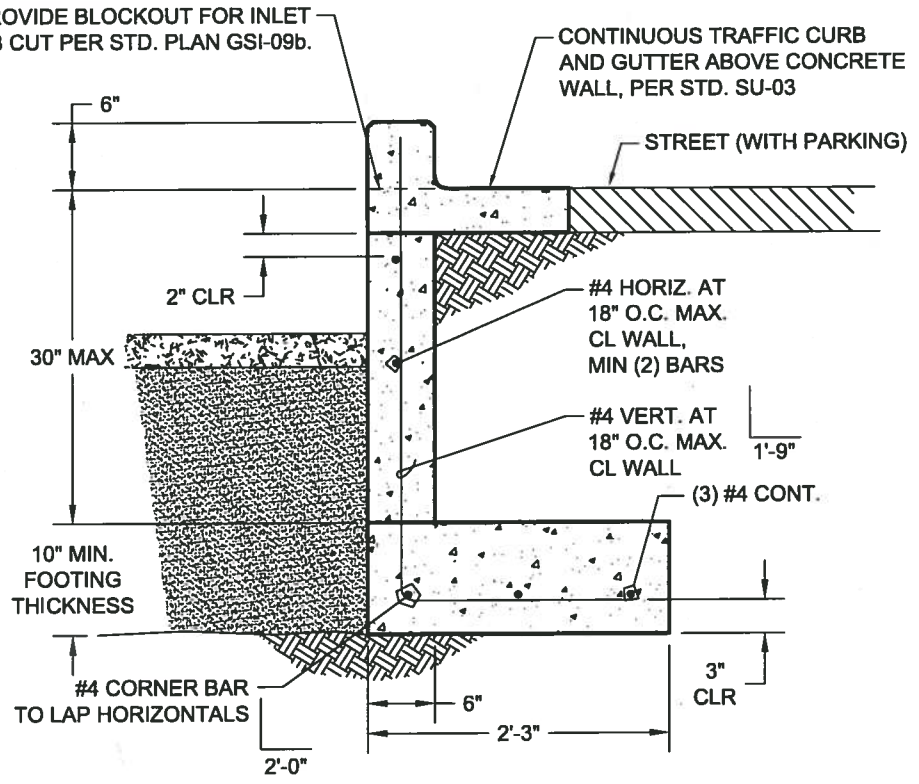

**RETAINING WALL WITH VEHICLE SURCHARGE**

NTS

**NOTES:**

1. Footings may be omitted if buttress is provided per Std. Plan GSI-06e.
2. Foundation subgrade shall consist of undisturbed native soils or compacted structural fill.
3. Retaining wall backfill shall consist of gravel backfill for walls per WSDOT 9-03.12(2).
4. Minimum concrete compressive strength ( $f_c$ ) shall be 3000 psi.
5. Steel reinforcing shall be A615 Grade 60 (60 ksi minimum yield strength).
6. See Std. Plan GSI-06a, GSI-06b, and GSI-06c for plan and section views.
7. Structural design per this sheet may only be used with Std. Plan GSI-06 series with no modifications.
8. Provide corner bars shown at all horiz. reinf. in walls and footings. Lap 2'-0" with horiz. reinf. typ.

REVIEWED BY  
 PUBLIC WORKS: *DCS*  
 ENVIRONMENTAL SERVICES: *GMS*  
 TACOMA POWER: *NA*  
 TACOMA WATER: *NA*



APPROVED FOR PUBLICATION  
 CITY ENGINEER: *[Signature]*  
 DATE: *2/2/12*

CITY OF TACOMA  
 WALLED BIORETENTION  
 WALLS AND  
 STRUCTURAL FOOTING  
 STANDARD PLAN NO. GSI-06d